

**SAFTD2**  
(SA2-Fitted)

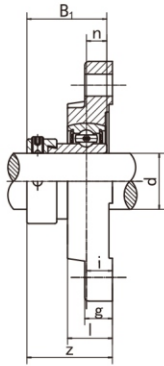

SAPFTD2

**Flange Unit**  
(Light duty)

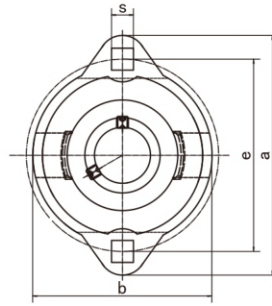

**SBFTD2**  
(SB2-Fitted)

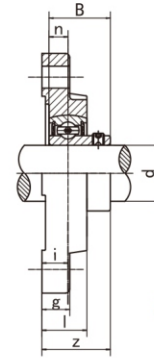

SBPFTD2

Unit NO.	Dimensions ( mm / in. )											Bolt Size mm/in.	Bearing No.	Housing No.	Weight (kg)
	d	a	e	b	i	s	g	l	z	B <sub>1</sub>	n				
SAPFTD 201 201-8	12 1/2	82	65	58	12	7.2	10.5	18	34.1	28.6	6.5	1/4	SA201 SA201-8	PFTD201	0.28
SAPFTD 202 202-9 202-10	15 9/16 5/8	3-1/4	2-9/16	2-9/32	15/32	9/32	27/64	45/64	1-11/32	1.1260	0.2559		SA202 SA202-9 SA202-10	PFTD202	
SAPFTD 203 203-11	17 11/16												SA203 SA203-11	PFTD203	
SAPFTD 204 204-12	20 3/4	94 3-11/16	71.5 2-13/16	66 2-39/64	12.5 1/2	8.7 11/32	11 7/16	19.5 49/64	36 1-27/64	31 1.2204	7.5 0.2953	5/16	SA204 SA204-12	PFTD204	0.38
SAPFTD 205 205-13 205-14 205-15 205-16	25 13/16 7/8 15/16 1	98 3-7/8	76.2 3	69 2-23/32	12.5 1/2	8.7 11/32	11 7/16	20 25/32	36 1-27/64	31 1.2204	7.5 0.2953	5/16	SA205 SA205-13 SA205-14 SA205-15 SA205-16	PFTD205	0.41
SAPFTD 206 206-17 206-18 206-19 206-20	30 1-1/16 1-1/8 1-3/16 1-1/4	116 4-9/16	89.5 3-17/32	81 3-13/64	13.7 35/64	10.3 13/32	13 33/64	22 55/64	40.4 1-19/32	35.7 1.4055	9 0.3543	3/8	SA206 SA206-17 SA206-18 SA206-19 SA206-20	PFTD206	0.64
SAPFTD 207 207-20 207-21 207-22 207-23	35 1-1/4 1-5/16 1/3/8 1-7/16	122 4-13/16	100 3-15/16	89 3-1/2	15.4 39/64	10.3 13/32	13 33/64	24 61/64	44.8 1-49/64	38.9 1.5315	9.5 0.3740	3/8	SA207 SA207-20 SA207-21 SA207-22 SA207-23	PFTD207	0.76

Unit NO.	Dimensions ( mm / in. )											Bolt Size mm/in.	Bearing No.	Housing No.	Weight (kg)
	d	a	e	b	i	s	g	l	z	B	n				
SBPFTD 201 201-8	12 1/2	82	65	58	12	7.2	10.5	18	28	22	6	1/4	SB201 SB201-8	PFTD201	0.25
SBPFTD 202 202-9 202-10	15 9/16 5/8	3-1/4	2-9/16	2-9/32	15/32	9/32	27/64	45/64	1-7/64	0.8661	0.2362		SB202 SB202-9 SB202-10	PFTD202	
SBPFTD 203 203-11	17 11/16												SB203 SB203-11	PFTD203	
SBPFTD 204 204-12	20 3/4	94 3-11/16	71.5 2-13/16	66 2-39/64	12.5 1/2	8.7 11/32	11 7/16	19.5 49/64	30.5 1-13/64	25 0.9843	7 0.2756	5/16	SB204 SB204-12	PFTD204	0.35
SBPFTD 205 205-13 205-14 205-15 205-16	25 13/16 7/8 15/16 1	98 3-7/8	76.2 3	69 2-23/32	12.5 1/2	8.7 11/32	11 7/16	20 25/32	32 1-17/64	27 1.0630	7.5 0.2953	5/16	SB205 SB205-13 SB205-14 SB205-15 SB205-16	PFTD205	0.37
SBPFTD 206 206-17 206-18 206-19 206-20	30 1-1/16 1-1/8 1-3/16 1-1/4	116 4-9/16	89.5 3-17/32	81 3-13/64	13.7 35/64	10.3 13/32	13 33/64	22 55/64	35.7 1-13/32	30 1.1811	8 0.3150	3/8	SB206 SB206-17 SB206-18 SB206-19 SB206-20	PFTD206	0.59
SBPFTD 207 207-20 207-21 207-22 207-23	35 1-1/4 1-5/16 1/3/8 1-7/16	122 4-13/16	100 3-15/16	89 3-1/2	15.4 39/64	10.3 13/32	13 33/64	24 61/64	38.9 1-17/32	32 1.2598	8.5 0.3346	3/8	SB207 SB207-20 SB207-21 SB207-22 SB207-23	PFTD207	0.73

Note: To specify relubricatable units, add "G" suffix, (e.g., SBPFTD205-16G)